



CONTIMED

BY CONTINEST



MOBILE INFRASTRUCTURE  
FOR TEMPORARY MEDICAL NEEDS





# CONTENTS

- 04 | About Us
- 05 | Continest – Achievements
- 06 | Innovation
- 07 | Continest Specifications
- 08 | Base Products
- 11 | The Continest Approach
- 12 | Problems & Challenges
- 13 | Trends – Shaping Our Future
- 14 | Covid 19 – What Have Learned So Far
- 15 | Solution | Product
- 16 | Products
- 23 | Use Cases
- 24 | Target Groups
- 26 | Alternative Solutions → Usp
- 27 | Operations

# ABOUT US

## INNOVATION IN DEPLOYABLE INFRASTRUCTURE SOLUTIONS

Continest started its activity at the end of 2016 with buying the IP of the 20' foldable container from Rob van den Berg, Dutch mechanical engineer. The first prototype was built in Q1 2017, followed by serial production. In 2018 we set up our first international branch and serviced international customers around Europe.

Continest is an innovative market-leading foldable container solution, specially developed for the purpose of relatively short-period usage anywhere there is a need for handling large crowds for temporary accommodation, office/meeting rooms, first aid, command post, guard post, storage, service area, cooling and heating purposes.

The essence of the Continest foldable solution is that the containers are uniquely developed for easy and quick set up and transport. **The solution offers an 80% cost cut on logistic and storage costs, and a similar reduction of CO<sub>2</sub> and GHG emissions.**

Continest aims to succeed both in the event market segment as well as provide innovative solutions to the health industry

and to the defense industry. Continest Technologies Plc is highly committed towards environmental issues and sustainable development which covers all areas of business relations.

Continest is present with local distributors in the UK & Ireland, Germany, Netherlands, Finland, Switzerland and Israel, UAE and KSA. The company is present in Canada, and it prepares its market entry in the USA.

Continest in cooperation with its strategical suppliers and partners started the development of the most advanced mobile temporary infrastructure solution, which can offer efficient and sustainable mobility, safety and autonomous operation for the specialists in the field.

CONTIMED medical unit was established by Continest Technologies Plc in 2020 with the aim to fulfill the market need of mobile medical infrastructure.

# CONTINEST – ACHIEVEMENTS

05

CONTINEST – THE MARKET LEADING DEPLOYABLE TEMPORARY INFRASTRUCTURE SOLUTION

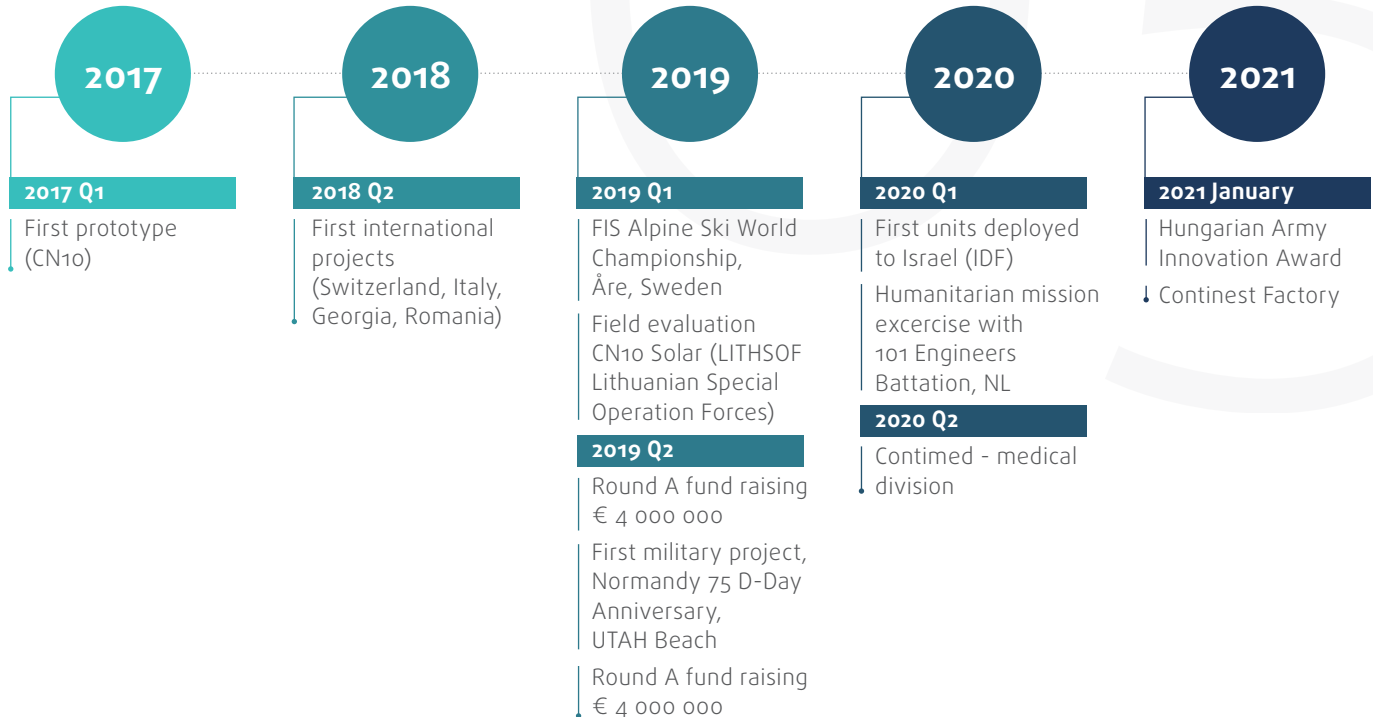



## INNOVATION IN DEPLOYABLE INFRASTRUCTURE SOLUTIONS

Continest foldable containers generate 80% savings on logistical costs, environmental impact and infrastructure requirements such as trucks, drivers, fuel and other associated requirements 20-24 units of CN10 or 10-12 units of CN20 folded containers can be transported on a standard or mega trailer.

Both base units were developed with the aim to be compatible with the most widely used machines and equipments: forklifts, cranes, wheel loader, telehandlers, side loader and hook lifts.

Besides its wide compatibility the other priority was operational safety. The system is developed with multiple safety layers, that prevent unintentional collapsing of the units, even when they are partially opened or stacked. The patented hinge mechanism is the key component responsible for safe and quick set-up and tear down.

The units are "plug&play", providing efficient deployment and relocation options to the end user. As the footprint of the units is identical with the 10' and 20' ISO containers the units can be shipped by rail, sea and air as well.

## CONTINES SPECIFICATIONS



**Safe** – due to the patented hinge mechanism the tear down of the unit is only possible with the deliberate usage of specific machinery and closing / opening of hinges.

**Modular** - The containers are modular, both the CN10 and the CN20 units can be connected, resulting in larger configurations.

The CN20 units are also stackable.

**Multifunctional** – accommodation, office, first aid, storage or any other purpose.

## THE CONTINEST SOLUTION



Due to the fact that up to 5 Continest units can be stacked during transport on a mega trailer results in a **80% decrease** of all logistical needs and costs (trucks, drivers, fuel and other associated costs, CO2 emissions).

**Product:** innovative & feasible  
**Promotion & Place:** user generated brand awareness

Trademark No.227509, Patent Registrations  
No. WO2019/064036, NCAE Code: 2054V

## FOLDABLE CONTAINER SOLUTION



Continest containers are stackable, easy to transport and easy to deploy. The aim is to provide temporary and/or flexible infrastructure for different use cases, as the functionality could be changed easily.



# BASE PRODUCTS

The base products of Continest are the CN10 (10') and CN20 (20') foldable containers. Driven by both customer demand and market development strategy a range of new products, applications and accessories have been developed and are under development:

## CN10



### Size (L×W×H)

Closed: 3000×2440×490 mm

Open: 3000×2440×2610 mm

Inner height: 2420 mm

Inner width: 2260 mm

Inner length: 2870 mm

**Weight:** 900 kg (1 truck=20 units)

## CN20



### Size (L×W×H):

Closed: 6058×2440×555 mm

Open: 6058×2440×2776 mm

Inner height: 2504 mm

Inner width: 2315 mm

Inner length: 5791 mm

**Weight:** 1800 kg (1 truck=10 units)

Trademark No.227509, Patent Registrations No. WO2019/064036, NCAGE Code: 2054V





# CONTINEST®

THE LEADING FOLDABLE CONTAINER SOLUTION





**CONTIMED**

# THE CONTIMED APPROACH

Continest developed **its foldable – IP protected – containers** for medical purposes **filling a niche for fast, durable, environmental friendly and efficient mobile medical infrastructure.**



As a **modular mobile medical infrastructure platform, Contimed** is used for various temporary needs in the public and private segments



**Contimed** is established by **Continest** company; initiated in 2020 by Continest team and external health professionals



Medical platforms have been deployed in **over 50 locations in the EU and UK**



Fast and easy deployment



**4** distributor partners **in Europe** and **1 in Israel & UAE**

Continest's green tech container solution cuts **80% of the logistic burden (€/€, CO<sub>2</sub> & GHG, storage).**

Proven track record with projects from Europe and the Middle East.



Focus on availability & capacity

Re-setting healthcare infrastructure

9x

Growth of natural disasters 1960/2019

'Disease X'

10 new diseases identified as future PANDEMIC

171 million in OECD countries

Growing number of events

NEED

- Mobile medical infrastructure
- Fast deployment
- Effective storage solution
- Modularity, Re-usability
- Durability, Scalability

Capacity  
Safety  
Prevention

CHALLENGE

- Slow deployment
- Expensive logistics
- Expensive storage
- Limited re-usage
- Efficiency

High ecological footprint

# TRENDS – SHAPING OUR FUTURE

## NEED FOR EXTRA CAPACITY

Additional temporary medical capacity is needed as people prefer to avoid crowded spots in traditional hospitals.

**Main challenges: physical distancing, risk of infection, mobility, sustainability.**

## INCREASING HEALTHCARE SPENDING

Private & state financed healthcare spending will increase as healthcare and prevention became hot topics.

**Main challenges: readiness for future pandemic, effectiveness, ROI, ecological footprint, storage/space capacity.**

## PUBLIC ENGAGEMENT/TRUST

Trust in public healthcare systems has been seriously damaged by the mismanagement of Covid-19.

**Main challenges: accessibility (testing, labs), security, capacity of beds, wards, ICUs.**

## AVOIDING LOCKDOWN

In case of a new wave of Covid-19 or similar pandemics, governments will refrain from lockdown, and focus on local measures.

**Main challenges: safety & rapidity utilizing mobile infrastructure (testing, ICUs, labs etc.).**

## THREAT OF PANDEMIC

Given the growing population and increasing mobility, the possibility of new pandemic or outbreaks of contagion is ever growing.

**Main challenges: readiness, storage/space capacity, speed of action.**

## NEED FOR EXTRA CAPACITY

Both natural and man-made disasters are becoming more frequent and more damaging.

**Main challenges: fast & deployable mobile medical and non-medical infrastructure.**

# COVID 19 – WHAT HAVE LEARNED SO FAR

## INEFFECTIVE

Waste of expenses  
Waste of resources

– PUBLIC TRUST +

## EFFECTIVE

Efficient use of public money  
Fast and reusable  
Environmental friendly  
Expandable

### CASE STUDY 01.

**USD 660M spent on field hospitals setup in event halls and other facilities in the US alone**, that, in many cases, were not used at all while certain local hospitals were overwhelmed by patients.



### CASE STUDY 02.

**Nursing homes in Canada, USA, Europe and other parts of the world have been hardly hit by the virus.** The operators of these facilities were not able to manage the situation. **The elderly who came back from hospital treatments infected other residents of the nursing home.** The lack of mobile medical infrastructure caused thousands of lives which could have been easily saved.



**SOLUTION – CONTIMED deployable and scalable Contimed facilities that can provide critical support where and when it's necessary. RELOCATABLE AND REUSABLE WHEREVER IT'S NEEDED.**

(Laboratory, Hospital capacity, Testing and Vaccination)



Source: [U.S. Field Hospitals Stand Down, Most Without Treating Any COVID-19 Patients](#)

**SOLUTION – CONTIMED deployable and scalable Contimed facilities (e.g. isolation unit stops spreading the virus in nursing homes) that can provide critical support where and when it's necessary. RELOCATABLE WHEREVER IT'S NEEDED.**

(Laboratory, Hospital capacity, Testing and Vaccination)



## INEFFECTIVE

Lack of mobile medical infrastructure  
Waste of human lives

– PUBLIC TRUST +

## EFFECTIVE

Efficient isolation stops the spread of the virus

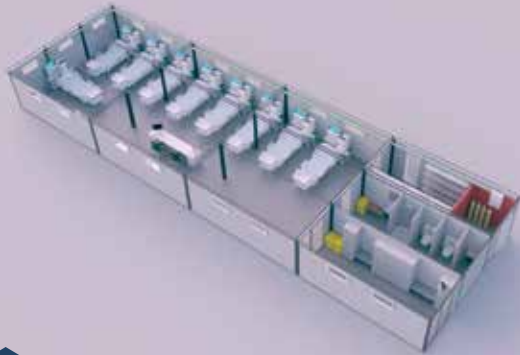

All medical solutions are based on Continest's container modules

- CN10 (10 feet container)
- CN20 (20 feet container)
- WetCell base units (water units included)

Contimed's on-site medical container infrastructure is based on Continest foldable containers and designed for various mobile healthcare infrastructure solutions:

- **SAMPLE COLLECTION & VACCINATION**
- **LAB TESTING, DENTAL CLINIC**
- **from FIRST AID POINTS up to complete ICU**



**NOTE:** Due to the units modularity Contimed containers can be easily fitted to all kind of customer needs.

# BASIC LABORATORY

WITH TEST AND VACCINATION UNIT

**Platform: Basic mobile laboratory unit  
test and vaccination base for mass PCR  
and/or LAMP testing and/or vaccination.**

The units made out of the following:

- Lab-base unit
- Sampling
- Administration
- Changing rooms
- WetCell unit

## End users:

- Medical institutions
- Municipalities
- Refugee camps
- Disasters areas
- NGOs
- Even organizers  
(cultural, sport, etc.)



**Example:**

**Units:** 8 CN10, 1 WetCell

**Logistics:** 1 truck



Ramsgate Airport | United Kingdom



# BSL2/ISO 7 LABORATORY

WITH TEST AND VACCINATION UNIT



Demonstration laboratory, Hungarian Charity Service of the Order of Malta, Budapest

**Platform: BSL2/ISO 7 mobile laboratory unit test and vaccination base for mass PCR or LAMP testing and/or vaccination.**

The units made out of the following:

- Lab-base unit (1 unit of 40 feet see container)
- Sampling and administration units
- Changing rooms
- WetCell units

## End users:

- Medical institutions
- Municipalities
- Refugee camps
- Disasters areas
- NGOs

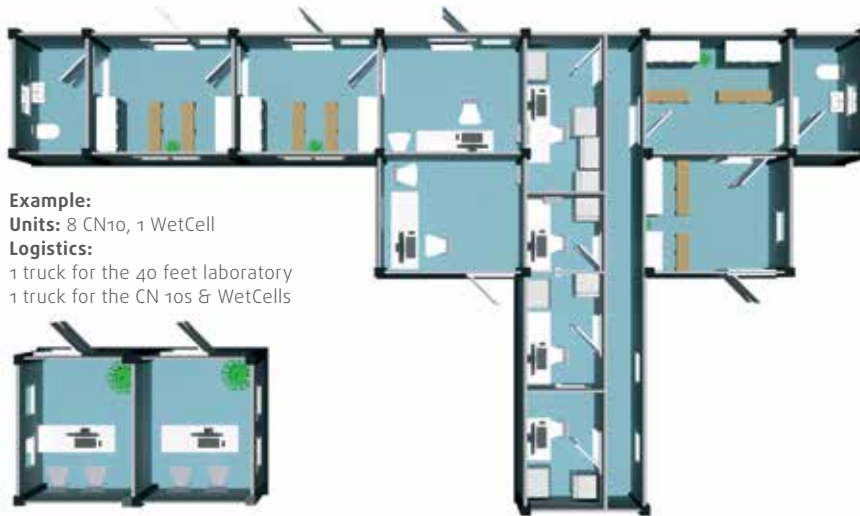

### Example:

**Units:** 8 CN10s, 1 WetCell

### Logistics:

1 truck for the 40 feet laboratory  
1 truck for the CN 10s & WetCells



# MOBILE DENTAL CLINIC

**Platform: Mobile platform for dentistry and screening service**

The units made out of the following:

- Dentistry unit
- Lobby and Administration
- WetCell unit
- X-ray unit

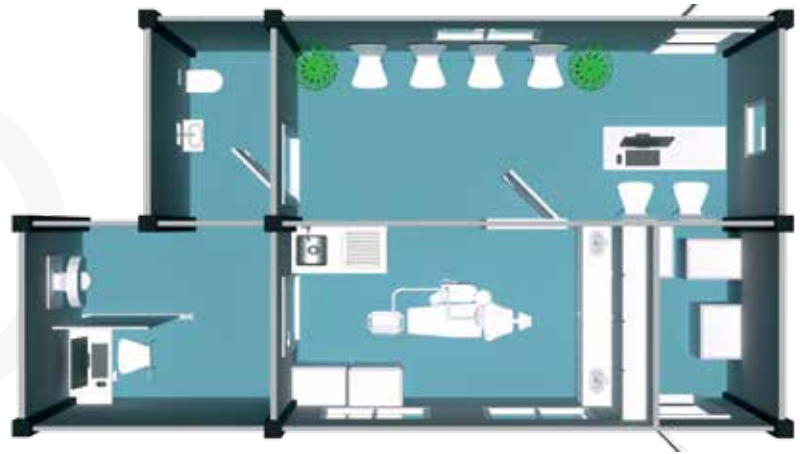

**Example:**

**Units:** 2 CN20, 1 CN10, 1 WetCell

**Logistics:** 1 truck

## End users:

- Municipalities
- Schools
- Corporations
- Refugee camps
- Disasters areas
- NGOs



# MOBILE OUTPATIENT UNIT

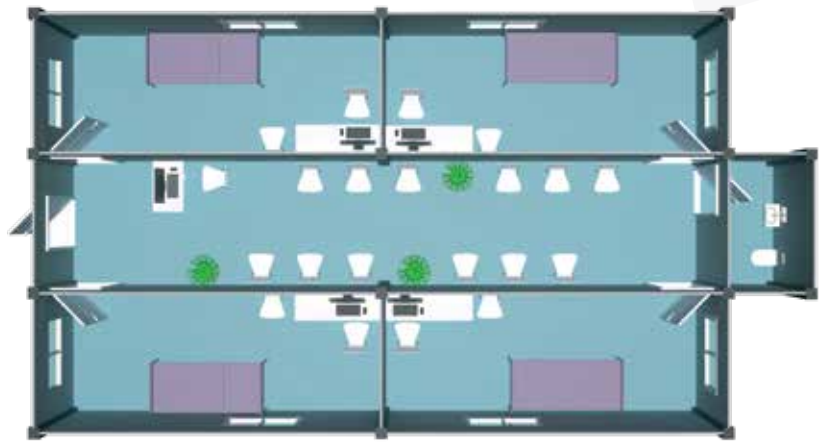

**Example:**  
**Units:** 6 CN20, 1 WetCell  
**Logistics:** 1 truck

**Platform: Mobile and modular outpatient unit for cases of capacity shortages**

The unit could be made out of the following:

- Examination rooms
- Lobby
- Administration
- WetCell unit



Exeter Hospital



**End users:**

- Medical institutions
- Municipalities
- Corporations
- Refugee camps
- Disasters areas
- NGOs

# MOBIL IMPATIENT WARD

**Platform: Mobile and modular ward for cases of capacity shortage**

The unit could be made out of the following:

- Inpatient ward
- Changing rooms
- Administration
- WetCell unit

## End users:

- Medical institutions
- Municipalities
- Refugee camps
- Disasters areas
- NGOs

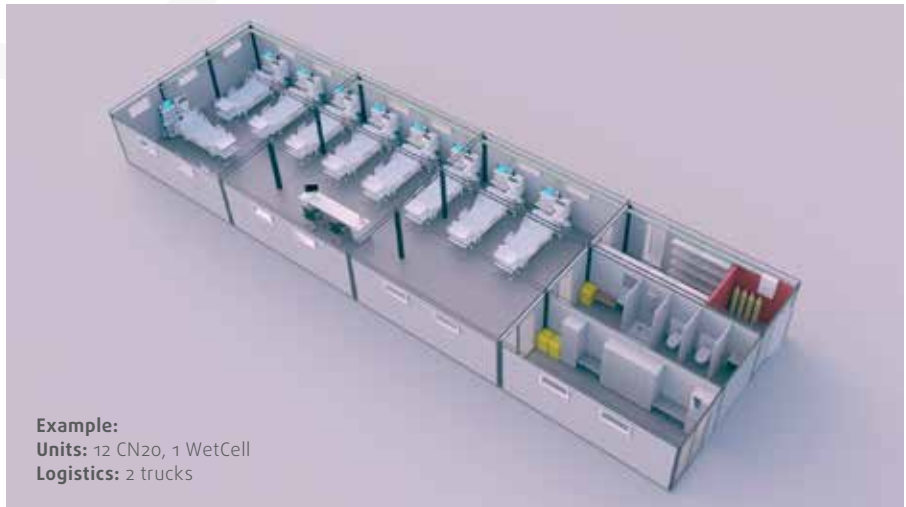

**Example:**

**Units:** 12 CN20, 1 WetCell

**Logistics:** 2 trucks

# MOBIL HOUSING BLOCKS

## FOR MEDICAL STAFF



Accommodation unit and WetCell



**Example:**  
**Units:** 3 CN10, 3 WetCell  
**Logistics:** 1 truck

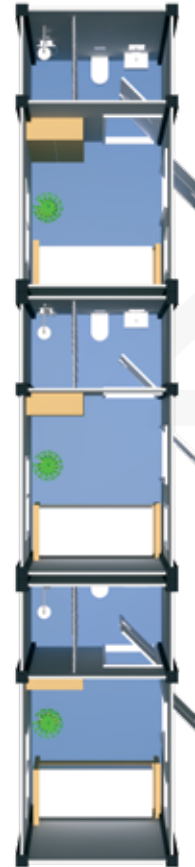

**Platform: Mobile and modular housing blocks designed for medical staff**

The unit could be made out of the following:

- Accommodation unit
- WetCell units

### End users:

- Medical institutions
- Municipalities
- Refugee camps
- Disasters areas
- NGOs

# OTHER PLATFORMS

**Platform: Various mobile medical platforms for cases of capacity shortages**

- Mobile hospital
- Mobile operating room
- Mobile screening unit
- Mobile ICU

## End users:

- Medical institutions
- Municipalities
- Corporations
- Refugee camps
- Disasters areas
- NGOs



Care Home Visitor Pod, Annacliffe Care Home in Blackpool | United Kingdom

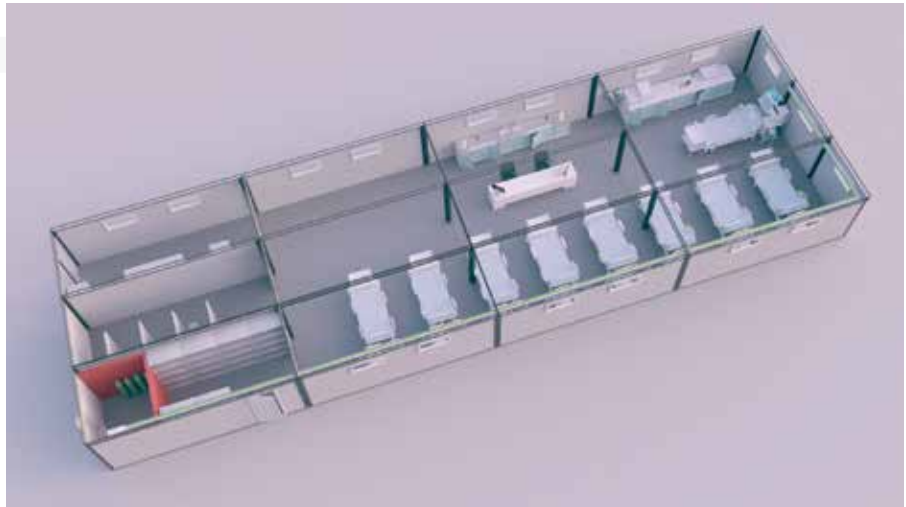

# USE CASES

## TEMPORARY INFRASTRUCTURE FOR VARIOUS NEEDS

Continest containers are stackable, easy to transport and easy to deploy. The aim is to provide temporary and/or flexible infrastructure for different use cases, as the functionality could be changed easily.

### USE CASES INCLUDE

#### Epidemic local/Pandemic – human and animal



- Mass testing and vaccination points
- Corporate testing
- Restart
- Traffic hubs (airports, ports, railway stations, border crossings)

#### Medical enhancement and deployment



- Extra capacity need for **hospital/clinic renovations**; isolation areas, intermediary rooms, first aid room, CT/MR unit, mobile respiratory capacities and ICU units, etc.



#### Ensuring safe events (sports, music, cultural other events – e.g religious)



#### Humanitarian crisis (migration, natural and man-made disaster)



Gatwick International Airport

# TARGET GROUPS

## CONTIMED PLATFORMS CAN BE ADOPTED TO

- Basic medical unit, diagnostical laboratory
- Sample collection unit, vaccination facility
- Screening point, isolation unit
- Respiratory room, first aid point & hub
- Occupational health room, comprehensive ICU (Intensive Care Unit) etc.



## THE END USERS OF CONTIMED COME FROM DIFFERENT AREAS, WITH SLIGHTLY DIFFERENT NEEDS

### PUBLIC



- National healthcare systems
- Governmental offices (Ministry of Foreign Affairs etc.)
- Defence + law enforcement (border, police etc.)
- Education
- Municipalities

### PRIVATE



- Healthcare service providers
- Multi-event organizers
- Infrastructure rental companies
- Sports clubs/National sports organizations
- UEFA/FIFA, IOC, NOCs, Giro/Vuelta, F1

### NGOs



- UN/WHO/UNDRR/Immigration AIDE
- Red Cross/Doctors Without Borders
- Foundations



<b>PUBLIC &amp; NGO</b>			
	<b>Motivation for use</b>	<b>Challenge</b>	<b>Example</b>
<b>National healthcare systems</b>	Extend their testing capacity in a short period of time	Need for high throughput testing capacity at event venues	<ul style="list-style-type: none"> <li>• Elderly care – UK</li> <li>• Budapest program</li> </ul>
<b>Municipalities</b>	Prepare for intense local testing/ vaccination wherever needed	Need to prevent local lock-downs and overcrowded situations	<ul style="list-style-type: none"> <li>• Vaccination sites</li> <li>• Hospital capacity increase e.g respiratory rooms</li> </ul>
<b>Defence &amp; law enforcement</b>	Provide large personnel with testing & vaccination capacity	Need for more durable and reusable mobile infrastructure	<ul style="list-style-type: none"> <li>• Testing &amp; vaccination sites</li> <li>• Isolation centres</li> </ul>
<b>Humanitarian missions and other organizations</b>	Continuation of aid programs in the developing countries	Basic medical units are needed across countries, where relocation is key	<ul style="list-style-type: none"> <li>• Red Cross, Swiss Cross, UN, UNICEF, EU</li> <li>• Doctors Without Borders</li> <li>• Bread for the World</li> </ul>
<b>Religious organizations</b>	Need to continue their extensive humanitarian activities	Need safe , quick and reliable testing infrastructure on-site	Charity Service of the Order of Malta
<b>PRIVATE</b>			
	<b>Motivation for use</b>	<b>Challenge</b>	<b>Example</b>
<b>Private healthcare</b>	Extend their testing capacity in a short period of time	Need to isolate potentially infected patients from others	Smart Covid Center BUD
<b>Multi event organizers</b>	Reopen large music and sports events (festivals, Olympic Games, UEFA/FIFA, NBA/NHL etc.)	Need for high throughput testing capacity at event venues	Formula 1 Covid-19 sample collection, Euro 2021, Expo Dubai
<b>Large corporations</b>	Need to re-start production and service in a safe environment	Need safe, quick and reliable testing infrastructure on-site	<ul style="list-style-type: none"> <li>• VW container lab</li> <li>• Amazon</li> <li>• Multinationals - Factories</li> </ul>

# ALTERNATIVE SOLUTIONS → USP

CURRENTLY THERE ARE MULTIPLE SOLUTIONS TO PERFORM TEMPORARY MEDICAL INFRASTRUCTURE BUT THERE ARE EITHER **LOGISTIC, FINANCIAL OR OTHER DRAWBACKS** OF THESE ALTERNATIVES



Event halls



Fixed frame containers



Mobile trailers



Tents

## REASONS FOR CONTIMED CONTAINER USAGE IN THE HEALTHCARE SECTOR

<b>Durability</b>	Not subjected to any environmental factors: <b>wind, dust, rain, hurricane, snow, ice, etc.</b>
<b>Scalability</b>	Can easily be <b>adjusted to clients needs (size, form, capacity, interior)</b> , <b>adaptable to different capacity requirements</b> (disaster management, pandemic response, post pandemic diagnostics and vaccination).
<b>Modularity</b>	<b>Due to its modular solution</b> , easily tailored to individual needs, <b>adaptable to different capacity requirements</b> (disaster management, pandemic response, post pandemic diagnostics and vaccination).
<b>Rapidity</b>	<b>Deployment and set up is fast (3 hours)</b> , rapid site <b>design and production is</b> tailored to clients' needs.
<b>Mobility</b>	Easy and cost effective to transport <b>since they are foldable – installation and dismantling are simple.</b>
<b>Efficiency</b>	Folded containers are easy and inexpensive to store, transport and setup ( <b>up to 80% savings in transportation and storage</b> ).
<b>Stability</b>	Very stable structures and they are not subjected to <b>environment or hygienic risks.</b>
<b>Usability</b>	While tents, halls or trailers can be used and utilized to limited cases containers <b>can flexibly be used in various industry segments from low to high safety and comfort levels.</b> Contimed solutions are <b>capable to meet the highest</b> medical requirements: <b>up to BSL4 BIOSAFETY LEVEL OR INTENSIVE CARE UNIT (ICU).</b>
<b>Comfort</b>	The <b>levels of comfort</b> varies and can be <b>adjusted to different circumstances.</b>



## KEY OPERATIONAL POINTS

### Manufacturing



- Continest co-operates with subcontractors in 3 different locations
- Current manufacturing capacity is 60 containers/month
- Continest own factory is under planning – plot and plant has already been selected
- Manufacturing capacity in the first phase will be 2000 containers/year

### Assembling (Szentendre, Székesfehérvár)



- Continest has its own assemble line where the final product is made
- Key technicalities are implemented in Continest's own assemble line

### Logistics



- Continest co-operates with subcontractors in 3 different locations
- Current manufacturing capacity is 60 containers/month

### Tech transfer



- By 2021



[www.contimed.eu](http://www.contimed.eu)