



MOBILE & MODULAR MEDICAL INFRASTRUCTURE



WORLD CLASS & SUSTAINABLE TECHNOLOGY

Contineast is a **foldable, green tech container solution** that cuts 80% of the logistic burden (transport, storage). Contineast developed its containers for medical purposes filling a niche for fast, durable, environmental friendly and efficient mobile/modular medical infrastructure. It has a **proven track record** with projects from Europe, Africa and the Middle East.



ENVIRONMENTALLY FRIENDLY APPROACH

- 80% Less Carbon footprint
- 80% Less Transport Cost
- 80% Less Storage Cost & Space



FAST DEPLOYMENT & BUILD UP

- ▶ Quick and easy set up and tear down
(on levelled surface 5 -10 mins/containers)
- ▶ Needed staff: 1 crew + 1 operator
(forklift/crane)
- ▶ Set-up and tear is easily, staff training is
provided by Continest



1-2 minutes
lifting

2-3 minutes
stabilizing

ready for
operation

5 minutes tear
down

Platform: Mobile Laboratory

The units made out of the following:

- Lab-base unit
- Sampling units
- Administration units
- Changing rooms
- Sanitary units

End users:

- Biochem companies
- Medical institutions
- Municipalities
- Refugee camps
- NGOs
- Veterinarians
- Natural parks

Example: Israel



Example: UK



Example: Spain

Platform: Mobile outpatient unit and examination room for cases of capacity shortages, humanitarian crisis, military usage and disaster management

The application can be made out of the following:

- Examination rooms
- Lobby/Waiting area
- Nurse/Doctors room
- Administration
- Sanitary units

End users:

- Medical institutions
- Municipalities
- Corporations
- Refugee camps
- Disasters areas
- NGOs



Platform: Rapidly deployable ward

The units made out of the following:

- Inpatient ward
- Changing rooms
- Administration
- Sanitary

End users:

- Medical institutions
- Municipalities
- Corporations
- Refugee camps
- Disasters areas
- NGOs



MOBIL PATIENT FACILITY with ROL 2 & ROL 2+ options

Platform: The facility is ideal for rapid deployment and handling in - and outpatient services. The units can be used for capacity enhancement and various mobile and modular medical needs.

- The concept is modular; can be optimized according to end users needs
- The platform is multifunctional; it can easily be transformed if necessary into examiners, first aid centers, immediate/limited OR, etc.
- Efficient mobility enables the user to deploy/re-deploy and dismantle the platform into several smaller units at different locations,
- The system is also ideal for supplement a medical facility, as it can provide immediate capacity solution
- The additional advantage of the system is that it does not contain complex and expensive technical elements (operating room, intensive care, etc.), but it can provide hospital services that is necessary to for emergency and inpatient care
- The ward capacity can easily be doubled, tripled.... etc.

MOBIL PATIENT FACILITY with ROL 2 & ROL 2+ options

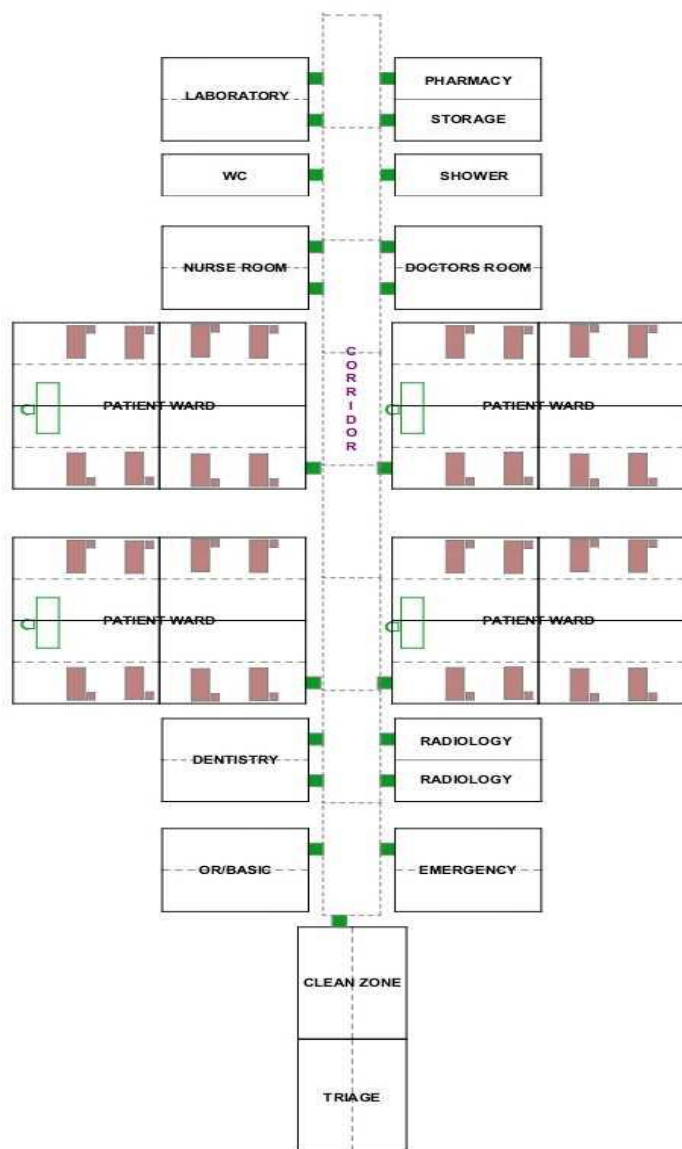

Platform: Due to modularity and scalability any type of medical units can be created out of Contineast containers

The units made out of the following:

- Field hospitals
- ICU
- Doctor's and nurses' rooms
- Dental clinic
- Screening units
- Etc.

End users:

- Medical institutions
- Municipalities
- NGOs
- Defence Agencies
- Governments
- Disaster Management Agencies
- Children camps



EMERGENCY PATIENT WARD – MULTIFUNCTIONAL UNIT: **REGIONAL REFERRAL HOSPITAL, SOROTI (UGANDA):**
*END USER: **WORLD HEALTH ORGANIZATION***

MOBILE LABORATORY – SAMPLING, TESTING AND ANALYZING LABORATORY: **TEL-AVIV (ISRAEL):**
*END USER: **AID GENOMICS (Biochem Corporation)***

MOBILE LABORATORY – SAMPLING, TESTING AND ANALYZING LABORATORY: **GRAND CANARIA (SPAIN):**
*END USER: **TRITON LABS/SMART HOSPITALS (Private Medical Company)***

MOBILE LABORATORY & OUTPATIENT UNIT – SAMPLING, TESTING AND ANALYZING LABORATORY, AND OUTPATIENT SERVICES: **14 LOCATIONS ACROSS UK (UNITED KINGDOM)**
*END USER: **NHS (National Health Service)***

EXAMINATION AND PATIENT WARD – MEDICAL UNIT FOR EMERGENCY CARE AND WARD: **FONYÓD (HUNGARY)**
*END USER: **ERZSÉBET CAMP (National Children Camping Organization)***

PEDIATRIC CLINIC – CHILDREN EXAMINATION AND TREATMENT UNIT: **ODESSA (UKRAINE)**
*END USER: **ODESSA REHABILITATION HOSPITAL (Southern Operation Command/Odesa Military District)***

CURRENTLY THERE ARE MULTIPLE SOLUTIONS TO PERFORM TEMPORARY MEDICAL INFRASTRUCTURE BUT THERE ARE EITHER **LOGISTIC, FINANCIAL OR OTHER DRAWBACKS** OF THESE ALTERNATIVES



Event halls



Fixed frame containers



Mobile trailers



Tents

REASONS FOR CONTIMED CONTAINER USAGE IN THE HEALTHCARE SECTOR

| | |
|--------------------|---|
| Durability | Not subjected to any environmental factors: wind, dust, rain, hurricane, snow, ice, etc. |
| Scalability | Can easily be adjusted to clients needs (size, form, capacity, interior), adaptable to different capacity requirements (disaster management, pandemic response, post pandemic diagnostics and vaccination). |
| Modularity | Due to its modular solution , easily tailored to individual needs, adaptable to different capacity requirements (disaster management, pandemic response, post pandemic diagnostics and vaccination). |
| Rapidity | Deployment and set up is fast (3 hours) , rapid site design and production is tailored to clients' needs. |
| Mobility | Easy and cost effective to transport since they are foldable –installation and dismantle are simple. |
| Efficiency | Folded containers are easy and inexpensive to store, transport and setup (up to 80% savings in transportation and storage). |
| Stability | Very stable structures and they are not subjected to environment or hygienic risks . |
| Usability | While tents, halls or trailers can be used and utilized to limited cases containers can flexibly be used in various industry segments from low to high safety and comfort levels . Contimed solutions are capable to meet the highest medical requirements: up to BSL4 BIOSAFETY LEVEL OR INTENSIVE CARE UNIT (ICU) . |
| Comfort | The levels of comfort varies and can be adjusted to different circumstances . |

